



Gatwick Airport Northern Runway Project

Traffic Regulation Plans – Speed Limits - For Approval

Book 4

VERSION: 1.0

DATE: JULY 2023

Application Document Ref: 4.9.1

PINS Reference Number: TR020005

Traffic Regulation Plans – Speed Limits – For Approval

Drawing Number	Revision	Drawing Title	Scale	Sheet Size
41700-XX-B-LLO-200111	P01	Traffic Regulation Plans – Speed Limits – APFP Regulations 5(2)(o) – Key Plan	1:7500	A1
41700-XX-B-LLO-200112	P01	Traffic Regulation Plans – Speed Limits – APFP Regulations 5(2)(o) – Sheet 1 – Existing Measures	1:2500	A1
41700-XX-B-LLO-200113	P01	Traffic Regulation Plans – Speed Limits – APFP Regulations 5(2)(o) – Sheet 2 – Existing Measures	1:2500	A1
41700-XX-B-LLO-200114	P01	Traffic Regulation Plans – Speed Limits – APFP Regulations 5(2)(o) – Sheet 1A – Proposed Measures	1:2500	A1
41700-XX-B-LLO-200115	P01	Traffic Regulation Plans – Speed Limits – APFP Regulations 5(2)(o) – Sheet 2A – Proposed Measures	1:2500	A1

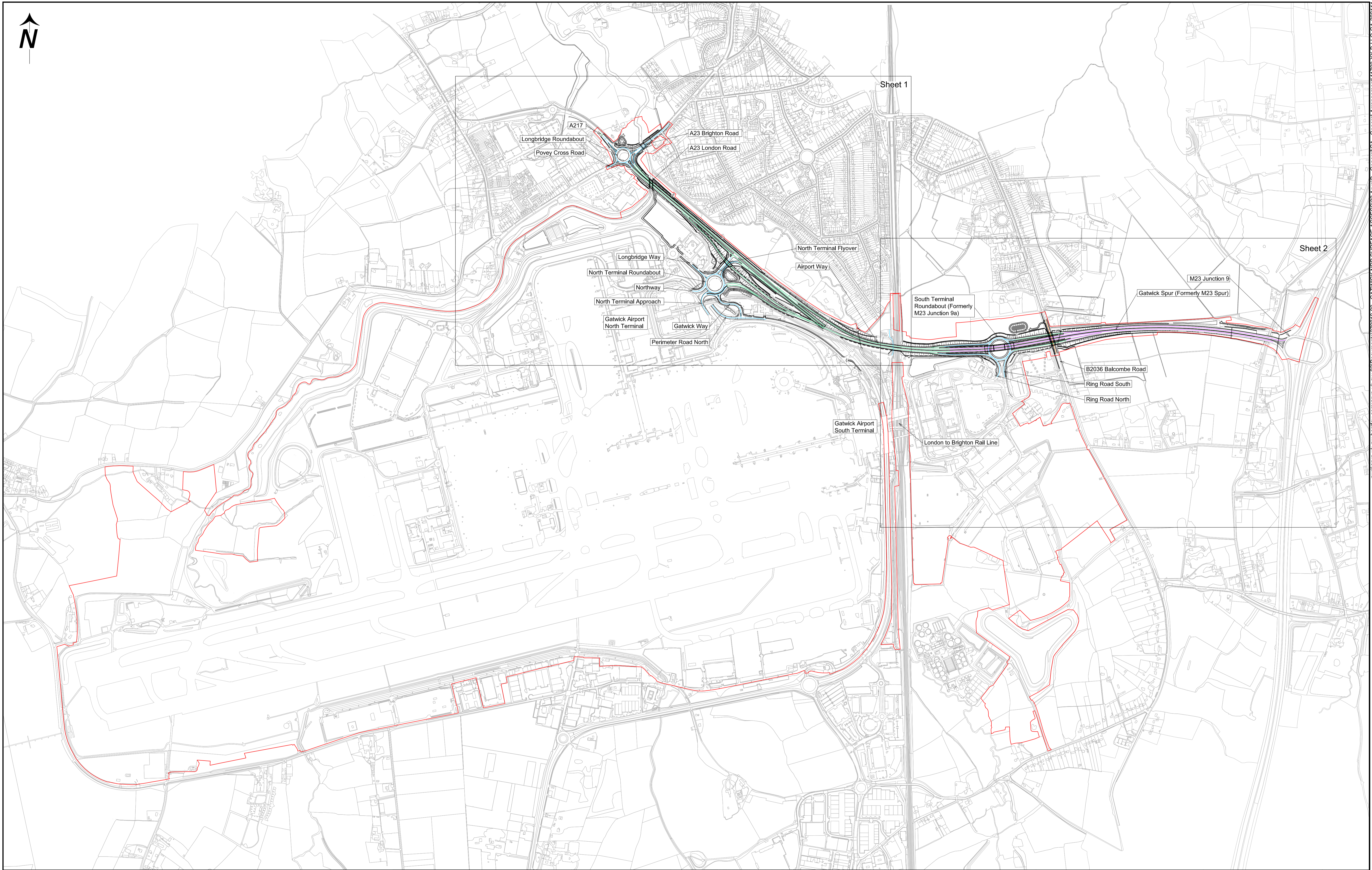

Sheet 1

Sheet 2

- Notes:
- 1) This drawing shall be read in conjunction with Schedule 6 Part 1 of the draft Development Consent Order (DCO) and accompanying application documentation.
 - 2) All dimensions, chainage and levels are in meters unless otherwise stated.
 - 3) Only written dimensions shall be used.
 - 4) This drawing set illustrates the extents of existing and proposed traffic regulation measures associated with Work Nos. 35, 36 and 37 only.

Legend:

	Order Limits		National Speed Limit for Dual Carriageway (70mph)
	County Council Boundary		National Speed Limit for Single Carriageway (60mph)
	Preliminary Scheme Design		Speed Limit (50mph)
			Speed Limit (40mph)
			Speed Limit (30mph)

© Crown copyright and database right. Ordnance Survey 100020071

Rev	Date	Revision Description	Dm	Chk	App
P01	1 st July 2023	DCO Application	NW	JF	DA



Project Name
Gatwick Airport Northern Runway Project

Title
**Traffic Regulation Plans
Speed Limits
APFP Regulations 5(2)(o)
Key Plan**

Scale 0 75 150 225 300 375 SCALE 1:7500m @ A1		For Approval Drawn Date 31/05/23 Status S4
Checked By JF	Checked Date 31/05/23	Drawn By NW
Approved By DA	Approval Date 31/05/23	Reason for Issue DCO Submission
Project Code-Location-Discipline-Volume-Type-Unique Number 41700- XX -B- LLO- GA - 200111		Revision P01

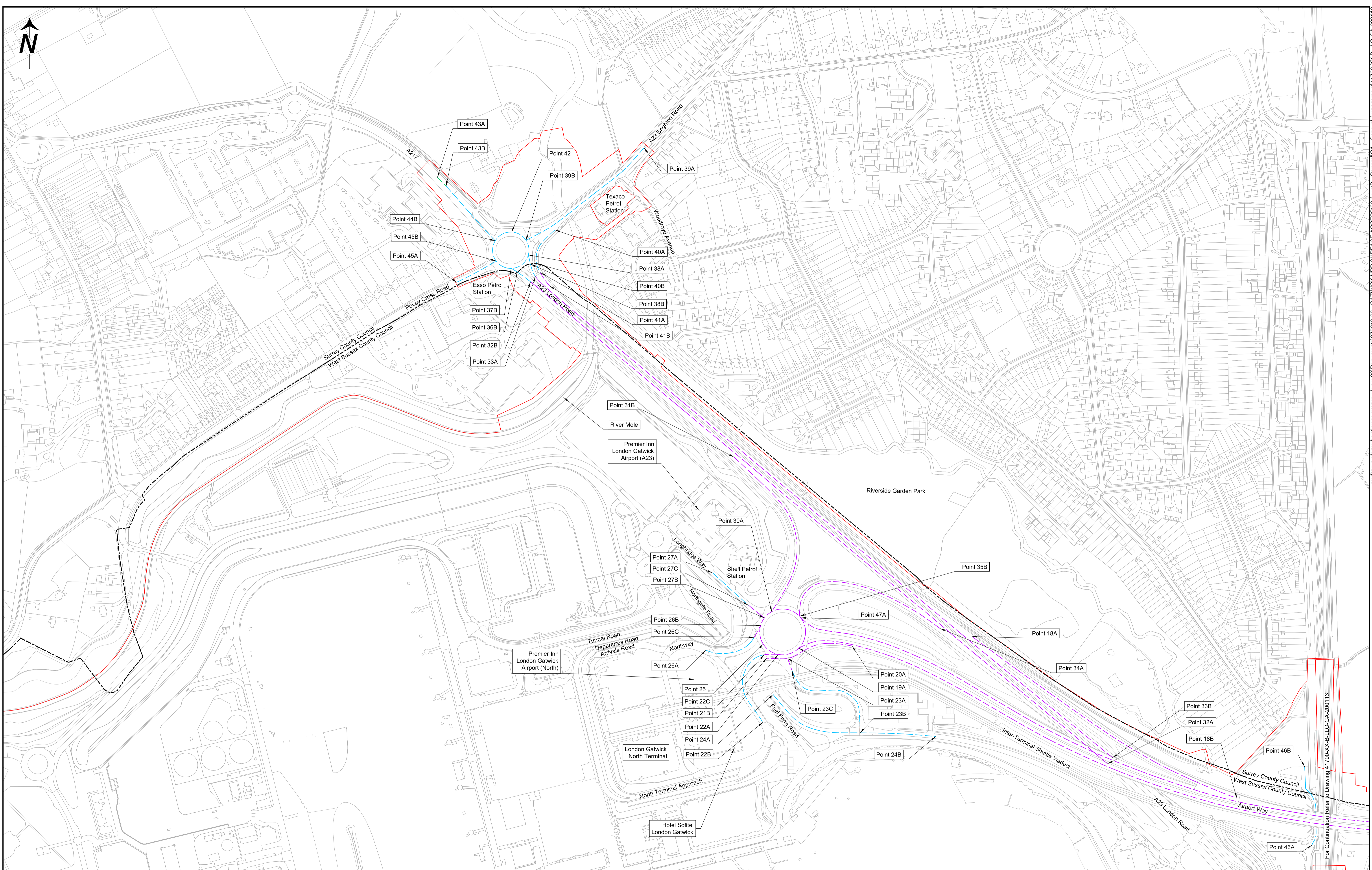

Notes:

- 1) This drawing shall be read in conjunction with Schedule 6 Part 3 of the draft Development Consent Order (DCO) and accompanying application documentation.
- 2) All dimensions, chainage and levels are in meters unless otherwise stated.
- 3) Only written dimensions shall be used.
- 4) This drawing set illustrates the extents of existing and proposed traffic regulation measures associated with Work Nos. 35, 36 and 37 only.

Legend:

	Order Limits		National Speed Limit for Dual Carriageway (70mph)
	County Council Boundary		National Speed Limit for Single Carriageway (60mph)
	Preliminary Scheme Design		Speed Limit (50mph)
			Speed Limit (40mph)
			Speed Limit (30mph)

© Crown copyright and database right. Ordnance Survey 10002071

Rev	Date	Revision Description	Dm	Chk	App
P01	1 st July 2023	DCO Application	NW	JF	DA



Project Name
Gatwick Airport Northern Runway Project

Title
**Traffic Regulation Plans
Speed Limits
APFP Regulations 5(2)(o)
Sheet 1 - Existing Measures**

Checked By JF	Checked Date 31/05/23	Drawn By NW	For Approval
Approved By DA	Approval Date 31/05/23	Reason for Issue DCO Submission	Drawn Date 31/05/23
Project Code-Location-Discipline-Volume-Type-Unique Number 41700- XX -B- LLO- GA - 200112			Status S4
			Revision P01

For Continuation Refer to Drawing 41700-XX-B-LLO-GA-200113
 pwl:slrup-up-pw.berkeley.com:up-sw-03/Documents/2791015-00 - GATWICK NRP SURFACE ACCESS/02 AnupB - General Arrangement/41700-XX-B-LLO-GA-200112

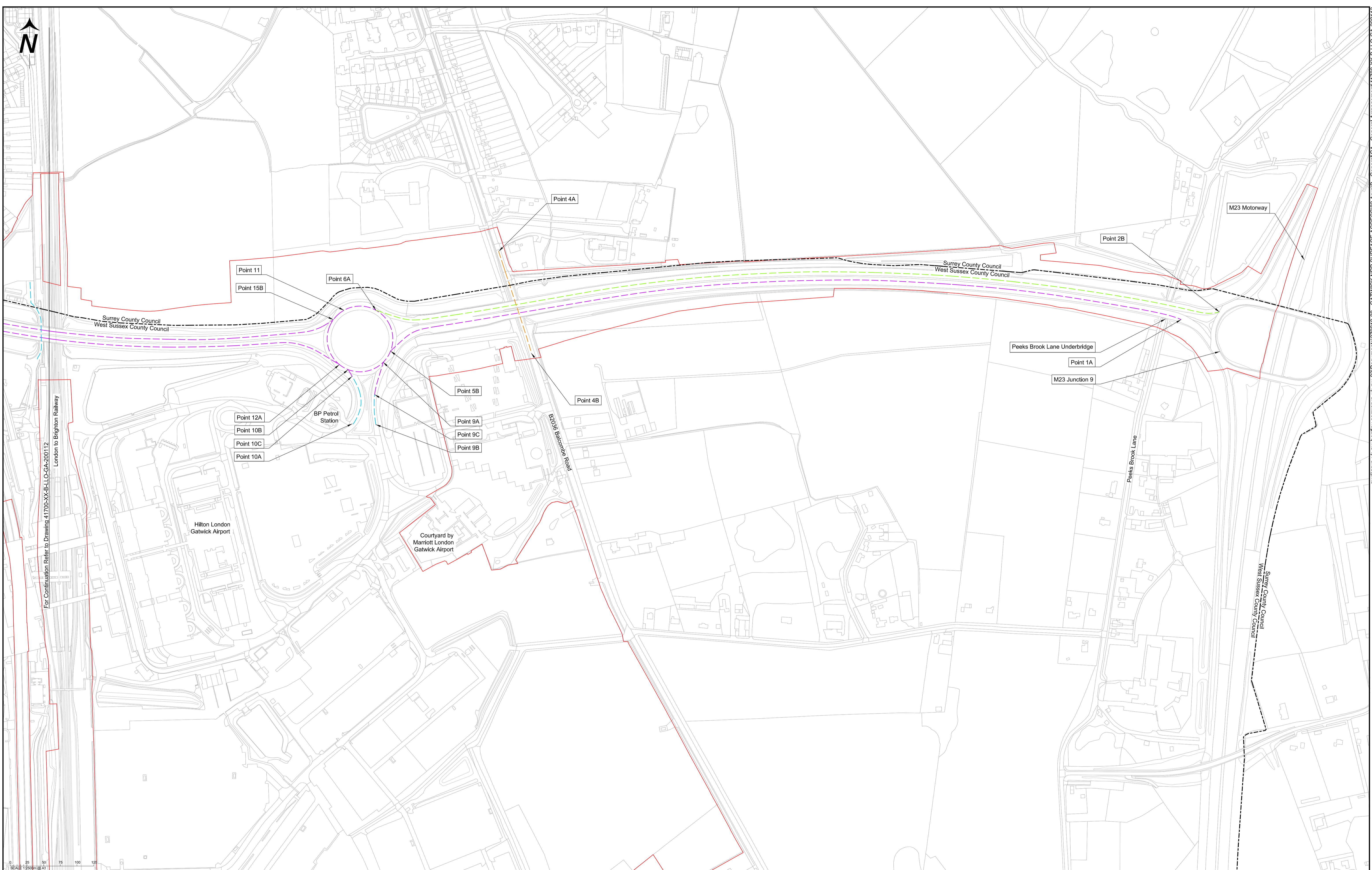

- Notes:**
- 1) This drawing shall be read in conjunction with Schedule 6 Part 3 of the draft Development Consent Order (DCO) and accompanying application documentation.
 - 2) All dimensions, chainage and levels are in meters unless otherwise stated.
 - 3) Only written dimensions shall be used.
 - 4) This drawing set illustrates the extents of existing and proposed traffic regulation measures associated with Work Nos. 35, 36 and 37 only.

Legend:

	Order Limits		National Speed Limit for Dual Carriageway (70mph)
	County Council Boundary		National Speed Limit for Single Carriageway (60mph)
	Preliminary Scheme Design		Speed Limit (50mph)
			Speed Limit (40mph)
			Speed Limit (30mph)

Rev	Date	Revision Description	Dm	Chk	App
P01	1 st July 2023	DCO Application	NW	JF	DA



Project Name
Gatwick Airport Northern Runway Project

Title
**Traffic Regulation Plans
Speed Limits
APFP Regulations 5(2)(o)
Sheet 2 - Existing Measures**

Checked By JF		Checked Date 31/05/23	Drawn By NW	For Approval
Approved By DA		Approval Date 31/05/23	Reason for Issue DCO Submission	Drawn Date 31/05/23
Project Code-Location-Discipline-Volume-Type-Unique Number 41700- XX -B -LLO - GA - 200113				Revision P01

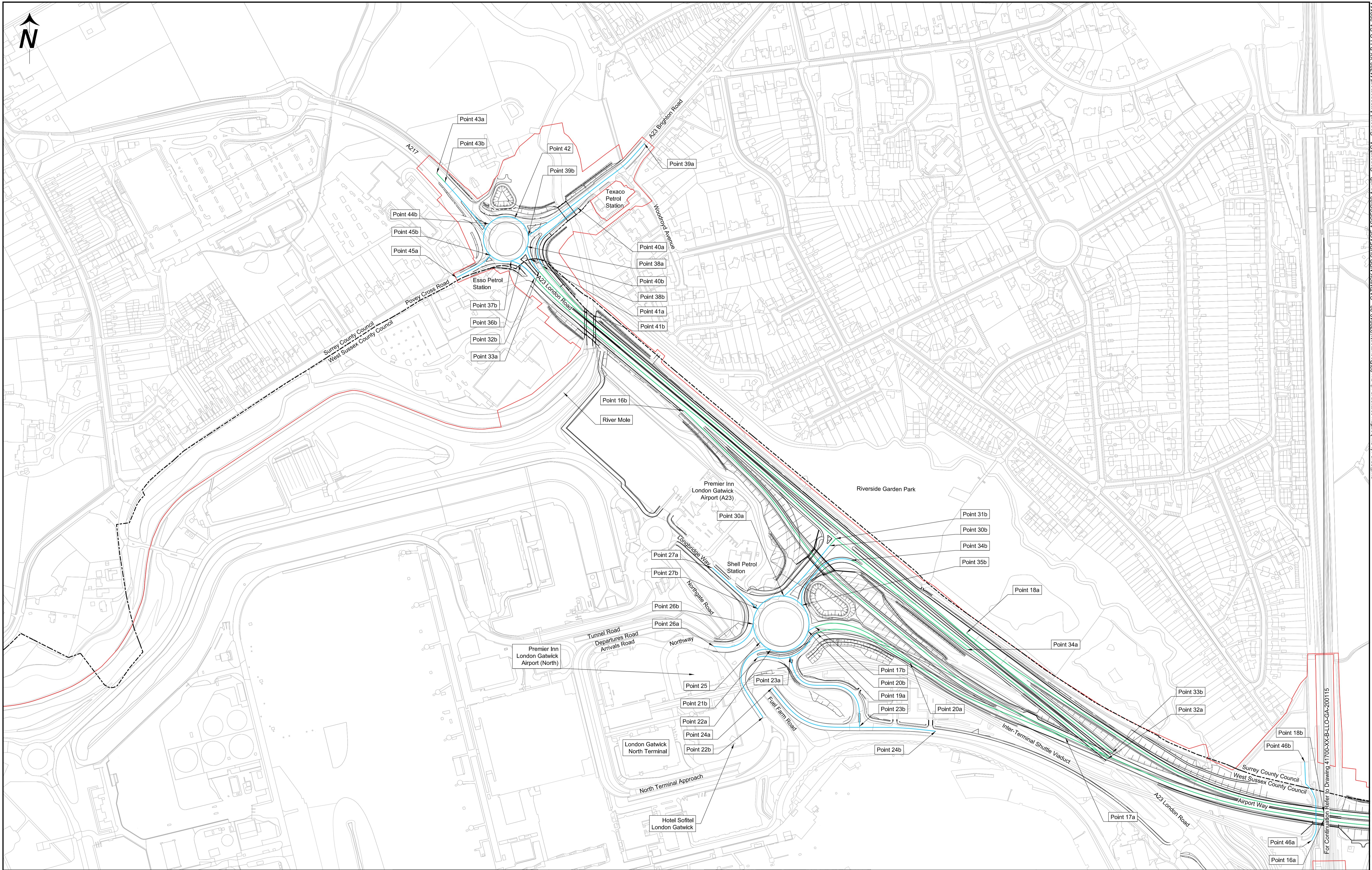

Notes:

- 1) This drawing shall be read in conjunction with Schedule 6 Part 1 of the draft Development Consent Order (DCO) and accompanying application documentation.
- 2) All dimensions, chainage and levels are in meters unless otherwise stated.
- 3) Only written dimensions shall be used.
- 4) This drawing set illustrates the extents of existing and proposed traffic regulation measures associated with Work Nos. 35, 36 and 37 only.

Legend:

	Order Limits		National Speed Limit for Dual Carriageway (70mph)
	County Council Boundary		National Speed Limit for Single Carriageway (60mph)
	Preliminary Scheme Design		Speed Limit (50mph)
			Speed Limit (40mph)
			Speed Limit (30mph)

© Crown copyright and database right. Ordnance Survey 10002071

Rev	Date	Revision Description	Dm	Chk	App
P01	1 st July 2023	DCO Application	NW	JF	DA



Project Name: Gatwick Airport Northern Runway Project

Title: Traffic Regulation Plans
Speed Limits
APFP Regulations 5(2)(o)
Sheet 1A - Proposed Measures

Scale: 1:2500m @ A1

For Approval

Checked By: JF	Checked Date: 31/05/23	Drawn By: NW	Status: S4
Approved By: DA	Approval Date: 31/05/23	Reason for Issue: DCO Submission	

Project Code-Location-Discipline-Volume-Type-Unique Number: **41700- XX -B- LLO- GA - 200114**

Revision: **P01**

For Continuation Refer to Drawing 41700-XX-B-LLO-GA-200115

ISO A1 Landscape

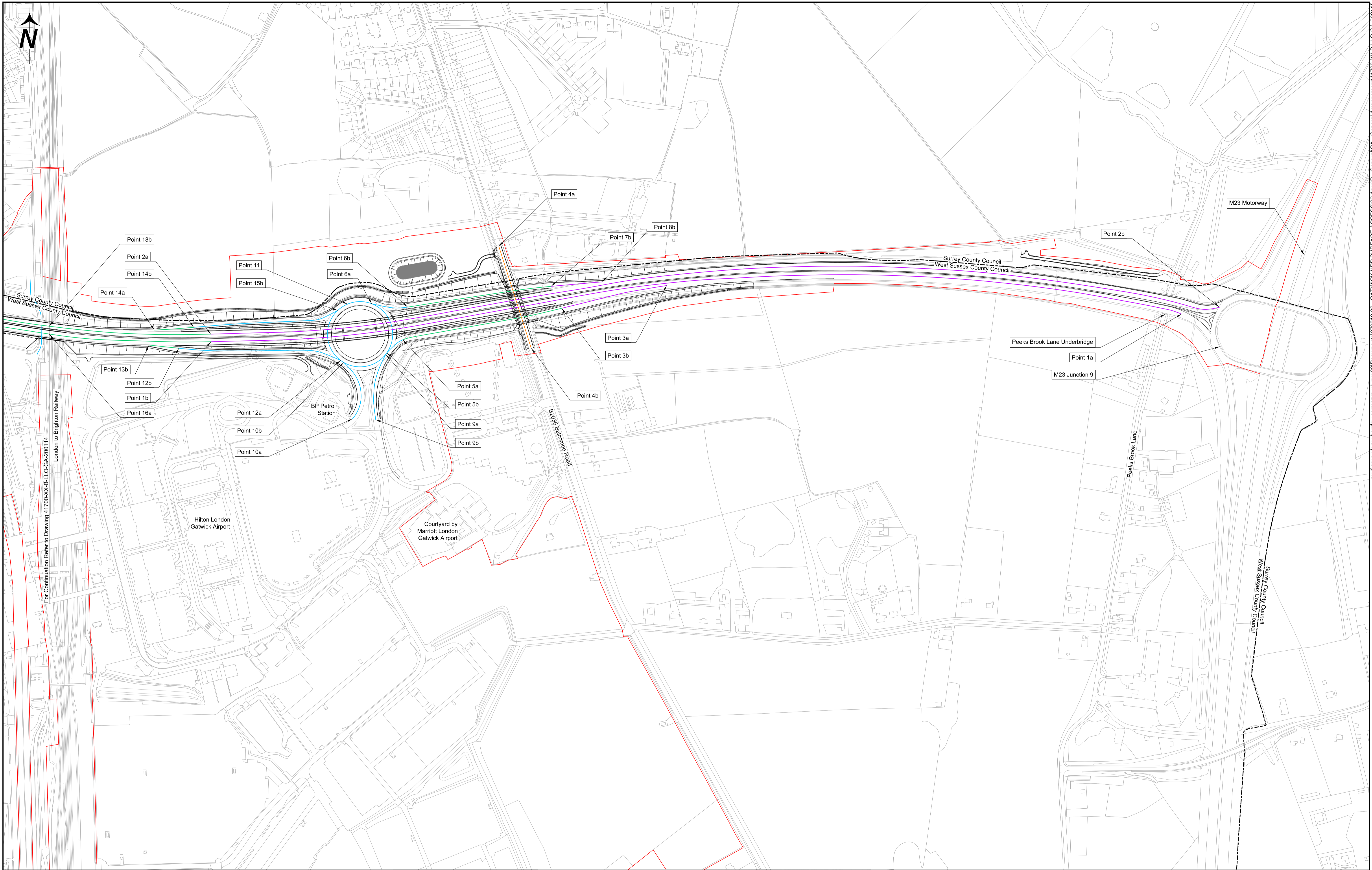

Notes:

- 1) This drawing shall be read in conjunction with Schedule 6 Part 1 of the draft Development Consent Order (DCO) and accompanying application documentation.
- 2) All dimensions, chainage and levels are in meters unless otherwise stated.
- 3) Only written dimensions shall be used.
- 4) This drawing set illustrates the extents of existing and proposed traffic regulation measures associated with Work Nos. 35, 36 and 37 only.

Legend:

	Order Limits		National Speed Limit for Dual Carriageway (70mph)
	County Council Boundary		National Speed Limit for Single Carriageway (60mph)
	Preliminary Scheme Design		Speed Limit (50mph)
			Speed Limit (40mph)
			Speed Limit (30mph)

© Crown copyright and database right. Ordnance Survey 100020071

Rev	Date	Revision Description	Drm	Chk	App
P01	1 st July 2023	DCO Application	NW	JF	DA



Project Name
Gatwick Airport Northern Runway Project

Title
**Traffic Regulation Plans
Speed Limits
APFP Regulations 5(2)(o)
Sheet 2A - Proposed Measures**

Scale 0 25 50 75 100 125 SCALE 1:2500m @ A1		For Approval Drawn Date 31/05/23 Status S4
Checked By JF	Checked Date 31/05/23	Drawn By NW
Approved By DA	Approval Date 31/05/23	Reason for Issue DCO Submission
Project Code-Location-Discipline-Volume-Type-Unique Number 41700- XX -B- LLO- GA - 200115		Revision P01